

EXHIBITOR PROSPECTUS

The **InfoAg** Conference

August 2 – 4, 2016

St. Louis Union Station Hotel
A Doubletree by Hilton • St. Louis, MO

SHOW ORGANIZERS



WHY SHOULD YOU EXHIBIT AT INFOAG 2016?



More Than 1500 Attendees In 2015!

Since 1994, the InfoAg Conference has been the premier event for the discussion and advancement of precision agriculture. This event draws interest from domestic and international agriculture professionals and features a wide range of educational and networking opportunities for professionals interested in learning more about precision agriculture techniques.

The **InfoAg 2016 Conference** will focus on the application of precision technology and information management for a wide array of crops including cotton, soybeans, corn and wheat. InfoAg is the perfect venue for you to grow and deepen your market relationships and place your company's brand in front of hundreds of qualified buyers ready to do business with your company.

WHO ATTENDS

- Precision Ag Consultants
- Crop Consultants/Scouts
- Farm Managers
- Academic/Extension Personnel
- Government Officials
- Growers

HOTEL INFORMATION



St. Louis Union Station Hotel

1820 Market St.
St. Louis, MO 63103

InfoAg 2016 Room Rates:
\$139.00+ tax

Reservation Deadline:
July 1, 2016

Phone: 855.271.3620

EXHIBITOR BENEFITS

- The opportunity to meet face-to-face with hundreds of leading growers and consultants.
- A program designed with the exhibitor in mind to ensure plenty of time for networking.
- Two full conference registrations with each booth space purchased.

Display Price: \$1,800.00 per booth

Display Space Features: Each booth comes furnished with the following items:

- 8' high draped back and 3' side skirting
- One (1) 6' draped table
- Two (2) folding chairs
- One (1) exhibitor identification sign 7" x 44"
- One (1) wastebasket

EXHIBITOR SERVICES

Heritage Exposition Services is the official exhibitor services contractor for the InfoAg 2016 Conference. Heritage Expo will email exhibitors a user-specific log-in and password in order to access their online, web store. This 2016 InfoAg exhibitor support site will include forms for ordering booth furnishings and booth material shipping and receiving instructions for both advance and show site shipping.

Heritage Exposition Services

620 Shenandoah Avenue
St. Louis, MO 63104
P: 800.360.4323 F: 314.534.8050
www.heritageexpo.com

Electrical/Internet Services

Electrical and Internet service will be provided by the St. Louis Union Station Doubletree Hotel engineering department. Order forms for these services will be included in the exhibitor service manual distributed by Heritage Expo and should be submitted directly to the hotel.

PRECISION^{Ag} TECH^{center}

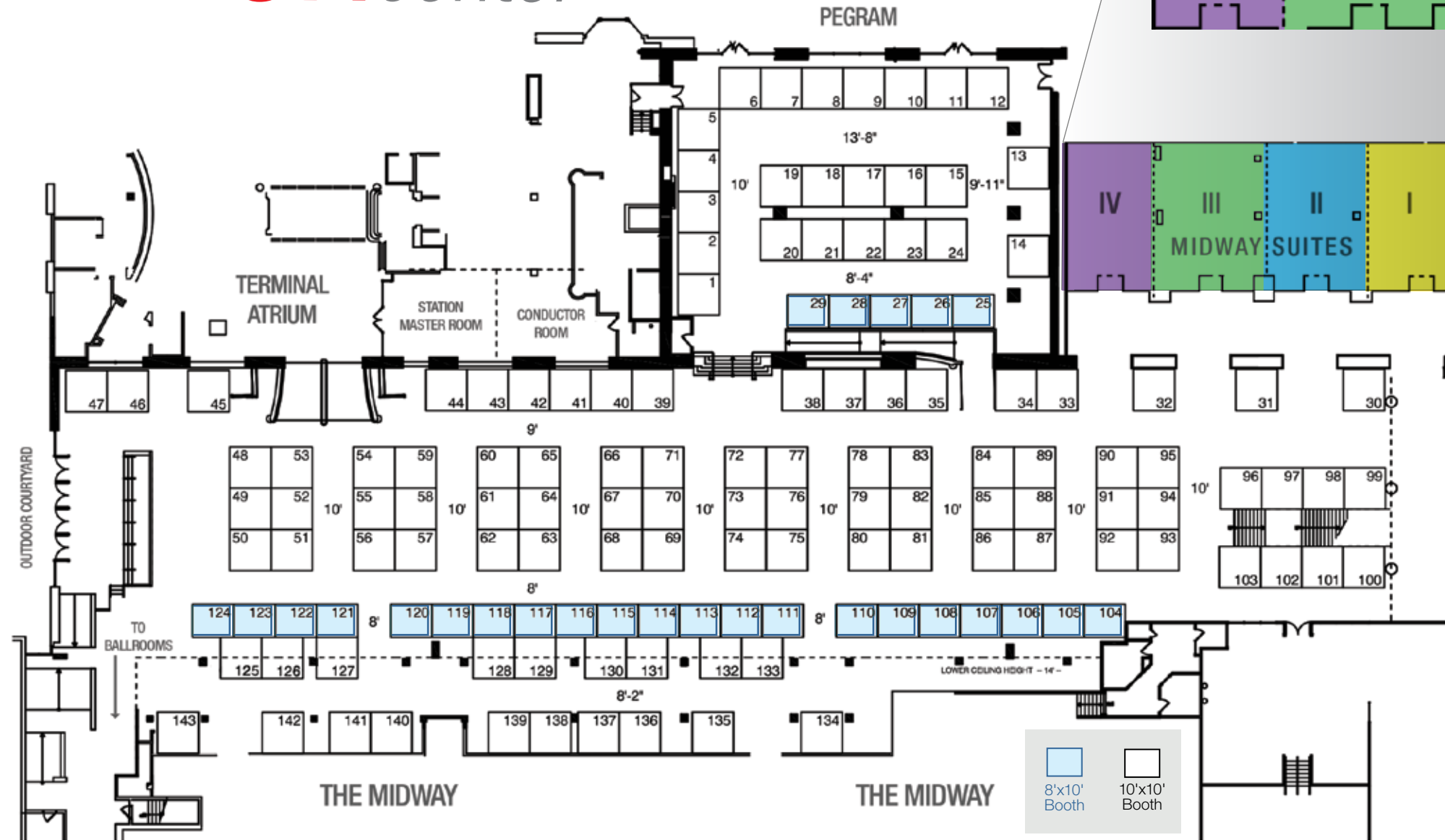

THE MIDWAY SUITES AT UNION STATION

- Midway Suite IV** 32' x 21'.3"
- Midway Suites III** 32' x 27'.9"
- Midway Suites II** 32' x 24'.6"
- Midway Suites I** 32' x 24'.6"

The Midway Suites at Union Station are located just off the trade show floor next to the Pegram room. These rooms accommodate 35-40 people each and can be configured as classroom or meeting-room seating. If you have a need for training, workshop or meeting space at InfoAg, the Midway Suites provide an excellent solution. Beverage, food and AV services available.

Contact your rep for further details

EXHIBITOR OPPORTUNITIES

PRECISIONAG TECH CENTER CHARGING STATION SPONSORSHIP

We will design and provide an attractive charging station highlighting your company name and products. Unit will include full color, back-wall graphics and accommodate up to six charging stations.

Charging Station Sponsorship: \$3,500



WINDOW CLING SPONSORSHIP

We will design and provide 4 window clings up to 8 sq. ft. each placed near the meeting rooms.

Window Cling Sponsorship: \$2,000
(2 available)



FLOOR CLING SPONSORSHIP

We will design and provide 4 floor clings up to 8 sq. ft. each placed around the exhibit hall.

Floor Cling Sponsorship: \$2,000
(2 available)



ELEVATOR CLING SPONSORSHIP

We will design and provide two full-sized elevator clings paced in the hotel elevators.

Elevator Cling Sponsorship: \$2,000



HOTEL KEY-CARD SPONSORSHIP

We will design and provide hotel room key-cards with your company logo and marketing message.

Hotel Key-Card Sponsorship: Contact your rep for further details





SEE WHO WAS THERE LAST YEAR

360 Yield Center	Ag Tester	Farmers Edge	MicaSense, inc.	Integrated LLC
Advanced	AgWorks Software	FarmLink	Midwest Laboratories	Soilmap
Reconnaissance	Agworld	Farmobile	Mixmate	SOYL
AgGateway Corporation	Ayrstone Productivity LLC	FIALab	My Ag Central	Spectrum Technologies
AGCO	Mavrx	FirstWater Ag	MyWayRTK	Spensa Technologies
AgEagle	Blackbridge	GEOSYS	New Holland	SST Software
AgJunction	CapstanAg	GEONICS LIMITED	Norac	FarmLogic-Soil Test Pro
Ag Leader Technology	Case IH	GeoVantage, Inc.	NovAtel, Inc.	TerraGo
AgRenaissance Software LLC	CDMS	GVM, Inc.	PAQ Interactive	The Climate Corporation
Agrian, Inc.	CropIMS	Hexagon Geospatial	PrecisionAg	The Fertilizer Institute
Agribotix, LLC	CropMetrics, LLC	iCropTrak	Precision Technologies	Trimble
Agricultural Retailers Association	Decisive Farming	I.F.A.R.M., Inc.	Raven Industries	Topcon Precision
AgriNews	DuPont Pioneer	Insero AgOtter	Satshot, Inc.	Agriculture
Ag Robotics	DTN/The Progressive	IPNI	ScoutPro, Inc.	Valley Irrigation
AgSource Laboratories	Farmer	IRROMETER Company	SGS North America, Inc.	Veris Technologies
AgSync, Inc.	ESRI	Iteris	SenseFly, Ltd.	Winfield Solutions
	Falcon Automated Soil Sampling	John Deere	Sky Imaging	XS, Inc.
		Mapshots	Software Solutions	ZedX, Inc.

HOW TO REGISTER

Each exhibitor receives two (2) complimentary full conference registrations with each booth space that is purchased. Additional exhibit hall passes for booth personnel can be purchased for \$250.00 per person. Additional full conference registrations can also be purchased, if desired.

Exhibitor registration information will be sent via email to all exhibitors prior to the show.

Questions on exhibitor registration, can be directed to Michelle Morgan at 217.762.7955 or email at registration@infoag.org



Send completed contracts to:

April Host CropLife
37722 Euclid Avenue,
Willoughby, OH 44094
P: 440-602-9221 F: 440-602-9363
E: ahost@meistermedia.com

Exhibit Sales Contacts:

Dan Bellanger
CropLife
P: 636.244.3310
E: dan@croplife.com

Rick Welder
CropLife
P: 440.602.9147
E: rick@croplife.com

Sal Settecase
CropLife
P: 440.602.9166
E: sal@croplife.com

Jack Lyttle
CropLife
P: 440.602.9136
E: jack@croplife.com

WWW.INFOAG.ORG